

- **Setting Lower Temperature Limit (LS)**

Long press button (SET) for 3 seconds,press button (+) or (-) until the code "LS" is illustrated on the temperature display screen,press button (SET) to confirm the code LS,press button (+) or (-) to adjust the correct limit setting range; Factory setting is 30.

- **Restore Factory Settings: press button (+) and (-) simultaneously more than 3S till DI sound heard,and 9-0 countdown on screen.**

- **Temperature sensor 10k**

**REMARK:**

- 1.Add water every one days (it depends on the environment and the amount of water inside the machine).
- 2.Do not open the lid frequently to increase the hatching rate.
- 3.Fertilized eggs are required for hatching.
- 4.There is a drain plug on the bottom of the machine, please do not discard.
- 5.In hatching period , remove the rolling trays from the incubator and put the white grid into the machine and place the eggs on the grid.

## INCUBATION TIPS:

Based on chicken eggs as an example for reference only

- **How to choose eggs before hatching?**

- 1.The eggs must be fresh. Generally, the fertilized eggs within 4-7 days after laying. And do not put them into the refrigerator or wash .
- 2.Take out the rotation shaft and place the eggs in the hatching grid after 18-day hatching period.

- **What are the precautions for hatching?**

- 1.Proper operation and careful observation are required during the incubation, Such as :add water to the machine every 1 to 2 days (it depends on the environment and the amount of water inside the machine).
- 2.Put machine into foam if environment temperature bellowed 20°C/68°F for better warm keeping.
- 3.Do not open the lid frequently during incubation, it'll make the unbroken eggshell dry out and difficult to be broken;
- 4.Check the development of eggs timely during the incubation period:

The 1st time to test egg (Day 5th-6th):mainly to check the fertilization of the eggs, select the unfertilized eggs, scattered yellow eggs, dead eggs.

The 2nd time to test egg (Day 11th-12th):mainly to check the development of egg embryo,the well-developed embryo is enlarged, with blood vessels inside, and the air chamber is large and sharply demarcated.

The 3rd time to test egg (Day 16th-17th):Light from the pointed side ,a well-developed embryo is larger, meanwhile full of egg, and no light in most places. If it's a dead egg,the blood vessels in the egg are blurred,Parts yellow near the air chamber,the boundary between the egg and the air chamber is not clear .

5.Hatching period (Day 19th-21th): It's into hatching period once cracks appeared on the eggshell, Meanwhile increase the humidity to ensure the eggshell soft enough to break,and decrease the temperature into 37 -37.5°C/98-99°F ;

- **How to better preserve the machine after hatching?**

Clean up and air-dry the machine timely after using, to prevent the electronic components from being damaged by internal moisture of the machine.

**Please refer to the temperature and humidity for different species below**

Egg Type	Hatching Days	Setter period	Hatcher period	Egg weight G
Chicken eggs	21	38.0°C(100°F)/55-70	37.5°C(99°F)/60-85	50-60
Duck eggs	28	37.8°C(100°F)/60-75	37.3°C(99°F)/65-85	80-100
Goose eggs	30	37.6°C(99°F )/65-80	37.1°C(98°F)/65-85	100-120
Quail eggs	18	38.5°C(101°F)/55-70	37.8°C(100°F)/65-85	30-40

Remark:It's normal within ±0.5°C difference between actual hatching and reference data

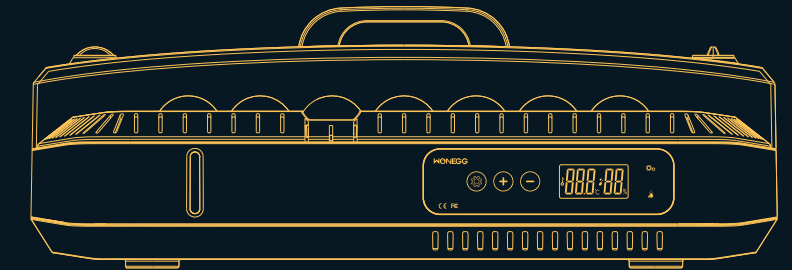

# EGG INCUBATOR USER MANUAL

**MODE:MINI-JJC35**

## EGG INCUBATOR STRUCTURE

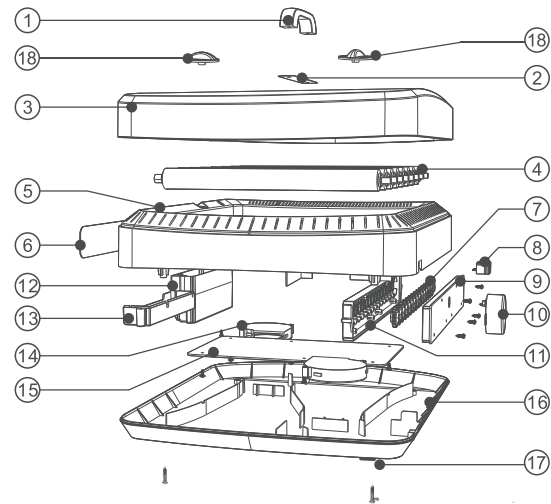

- |                     |                  |                      |
|---------------------|------------------|----------------------|
| ① Handle            | ⑦ Gear           | ⑬ PCB Cover          |
| ② Label             | ⑧ Power Socket   | ⑭ Turbo-fan          |
| ③ Transparent Cover | ⑨ Gear Box Base  | ⑮ Heater             |
| ④ Roller Egg Tray   | ⑩ Motor          | ⑯ Base               |
| ⑤ Middle Frame      | ⑪ Gear Box Cover | ⑰ Drain Plug         |
| ⑥ Control Panel     | ⑫ Water Tank     | ⑱ Ventilation switch |

### INDICATOR LIGHT FUNCTION

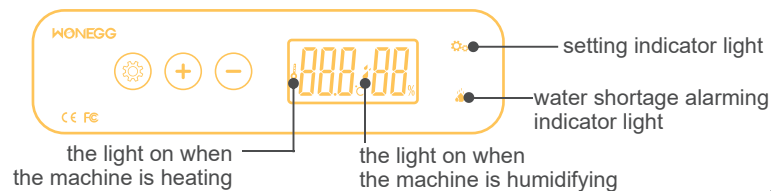

## IMPORTANT NOTE

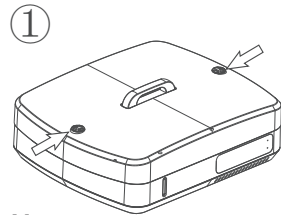

**Vent**  
Adjust the grey vent button ,waiting 2-3 hours until the humidity reading is stable ,close the vent to increase humidity or open the vent to decrease the humidity .

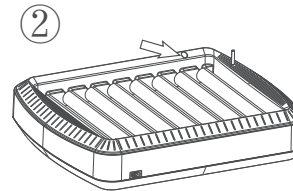

**Adding water hole**  
Remember to add water when use the machine in first time ,can hold 2000ML water .

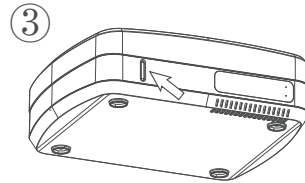

**Water Mark**  
It will alarm when lack of water ,add water in time .

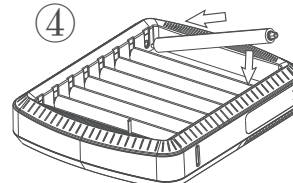

**How to put egg trays**  
Kindly note that the two ends of rolling egg tray are in different sizes .

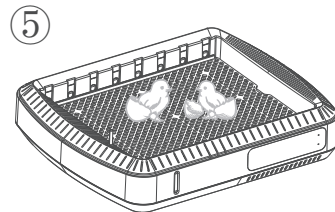

**Hatching period**  
Remove the roller egg tray from the incubator ,put the grid back for hatching .

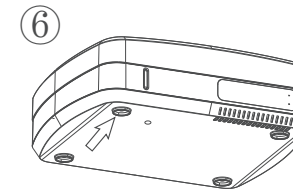

**After finish hatching**  
Pull out of drain plug ,drain the remaining water, make the machine clean and dry for next incubation .

## OPERATION INSTRUCTION

### ● Temperature Setting

Press button (SET) once, press button (+) or (-) to set required temperature, press button (SET) to save it, the factory setting temperature is 38°C/100°F

### ● Humidity Setting(AS)

Long press button (SET) for 3 seconds, press button (+) or (-) until "AS" is illustrated on the temperature display screen, press button (SET) to confirm AS, press button (+) or (-) to set required humidity ; Factory setting is 45.

### The Non professional do not suggest to adjust follow Parameter

### ● Setting Temperature Alarm (AL,AH)

1. Setting low temperature alarm(AL): Long press button (SET) for 3 seconds, press button (+) or (-) until "AL" is illustrated on the temperature display screen, press button (SET) to confirm AL, press button (+) or (-) to set required low temperature alarm value; Factory setting is 1°C/2°F.

2. Setting high temperature alarm(AH): Long press button (SET) for 3 seconds, press button (+) or (-) until "AH" is illustrated on the temperature display screen, press button (SET) to confirm AH, press button (+) or (-) to set required high temperature alarm value; Factory setting is 1°C/2°F.

### ● Calibrating Temperature Sensor Reading (CA)

Long press button (SET) for 3 seconds, press button (+) or (-) until the code "CA" is illustrated on the temperature display screen, press button (SET) to confirm CA, press button (+) or (-) to adjust the correct temperature ; Factory setting is 0.

### ● Setting Higher Temperature Limit (HS)

Long press button (SET) for 3 seconds, press button (+) or (-) until the code "HS" is illustrated on the temperature display screen, press button (SET) to confirm the code HS, press button (+) or (-) to adjust the correct limit setting range; Factory setting is 39.5°C/103°F.